

DOUBLE-DUTY PUB SHED

MATERIALS LIST

ITEM	QTY.
FOUNDATION	
60-lb. bags of gravel	40
6x6 x 12' treated lumber (Beams)	3
FLOOR	
2x6 x 16' treated lumber (Joists)	14
2x8 x 16' treated lumber (Skirt)	2
2x8 x 14' treated lumber (Skirt)	2
4' x 8' x 3/4" T&G floor panels (Floor)	9
WALL FRAMING	
2x4 x 10' SPF (Spruce, pine, fir) lumber (Plates)	4
2x4 x 12' SPF lumber (Plates)	7
2x4 x 16' SPF lumber (Plates)	2
2x4 x 8' SPF lumber (Gable end plates)	4
2x4 x 12' SPF lumber (Gable end plates)	2
4x4 x 8' SPF treated lumber (Posts)	2
2x4 x 92-5/8" SPF lumber (Studs)	60
2x4 x 16' SPF lumber (Temporary bracing)	6
4' x 8' x 1/2" LP SmartSide, no groove (Siding and bar door)	13
4' x 8' x 1/2" OSB oriented strand board (Gable end sheathing)	4
DECKING	
1" x 5-1/2" x 12' deck boards (Trex)	12
1" x 5-1/2" x 16' deck boards (Trex)	2
LOFT FLOOR	
2x8 x 16' SPF lumber (Rim joists)	4
2x8 x 12' SPF lumber (Joists)	12
ROOF FRAMING	
2x8 x 18' SPF lumber (Ridge)	1
2x6 x 18' SPF lumber (Subfascia)	2
2x6 x 10' SPF lumber (Rafters)	26
4' x 8' x 7/16" LP Silver Tech (Roof sheathing)	13
EXTERIOR SIDING AND TRIM	
4' x 8' x 3/8" LP SmartSide, 4" groove (Porch ceiling)	3
SmartSide Shake panels	As needed
12" x 16' x 3/8" LP SmartSide (Soffit)	6
1x2 x 16' LP SmartSide (Trim or similar)	18

1x3 x 16' LP SmartSide (Trim or similar)	6
1x4 x 16' LP SmartSide (Trim or similar)	7
1x6 x 16' LP SmartSide (Trim or similar)	12
1x8 x 16' LP SmartSide (Trim or similar)	6
1" x 9-1/4" x 16' LP SmartSide (Trim or similar)	4
1" x 5-1/2" x 16' LP SmartSide (Trim or similar)	4
WINDOWS	
1x4 x 6' pine (Window frames)	8
1x2 x 8' pine (Window stops)	8
2x4 x 10' SPF lumber (Window sill)	1
22" x 29" 4-lite barn sash	1
22" x 41-5/16" 6-lite barn sash	3
DOORS	
36" x 80" door and frame (Prehung exterior door)	1
ROOFING	
No. 15 roofing paper	3 rolls
Starter shingles	40 lin. ft.
Shingles	425 sq. ft.
Cap shingles	20 lin. ft.
1-1/4" roofing nails	10 lbs.
10' lengths of metal drip edge (Optional)	8
Construction adhesive	2 tubes
Caulk	6 tubes
HARDWARE	
10' lengths of 1-1/2" drip cap	8
2-1/2" galvanized butt hinges	8
#8 x 32 x 1-1/4" machine screws, nuts and washers	16
Stanley No. 1727 Storm Window Adjusters	4 pairs
BAR DOOR HARDWARE	
4" T-strap hinges	3
Eye bolts	4
3/16" x 5-1/2" eye/eye turnbuckle	2
Carabiners	4
Hasp	2

ENTRY DOOR HARDWARE	
Locking entrance knob	1
8d galvanized box nails	5 lbs.
16d galvanized box nails	5 lbs.
16d sinkers (Framing nails)	15 lbs.
8d sinkers (Framing nails)	15 lbs.
2" ring shank siding nails	10 lbs.
4d galvanized box nails	2 lbs.
1-1/4" corrosion-resistant construction screws	2 lbs.
Deck screws	5 lbs.
3" corrosion-resistant construction screws	2 lbs.
4x4 post brackets	2
Framing anchors (Joist to beam—alternate joists)	12
2x8 joist hangers	18
Joist hanger nails	2 lbs.
Wood shims	4 pkgs.

Figure A Double-Duty Pub Shed

OVERALL DIMENSIONS (INCLUDING OVERHANGS):

14' 6" W x 15' T x 18' 1" D

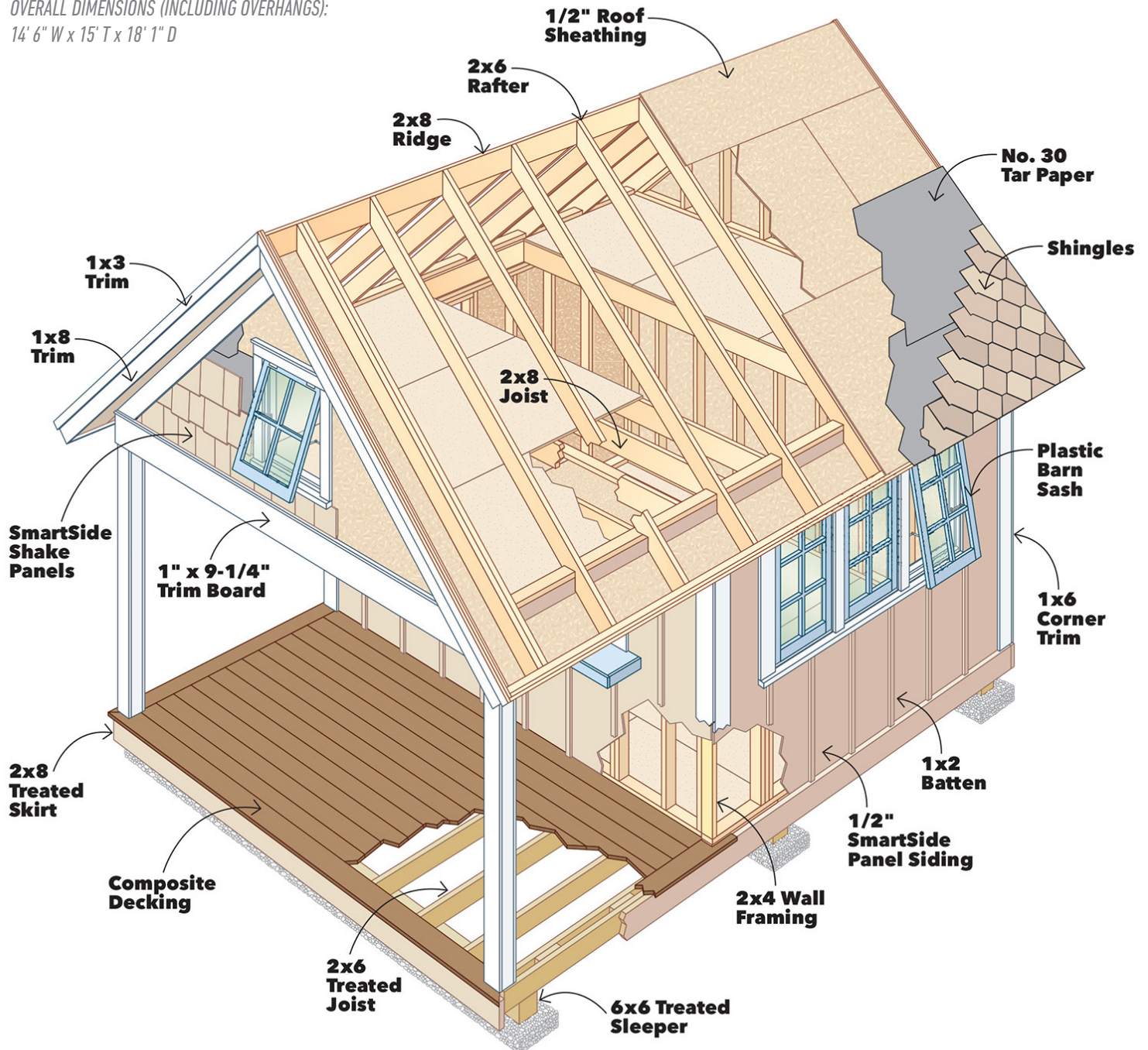

Figure B
Floor Framing and Flooring

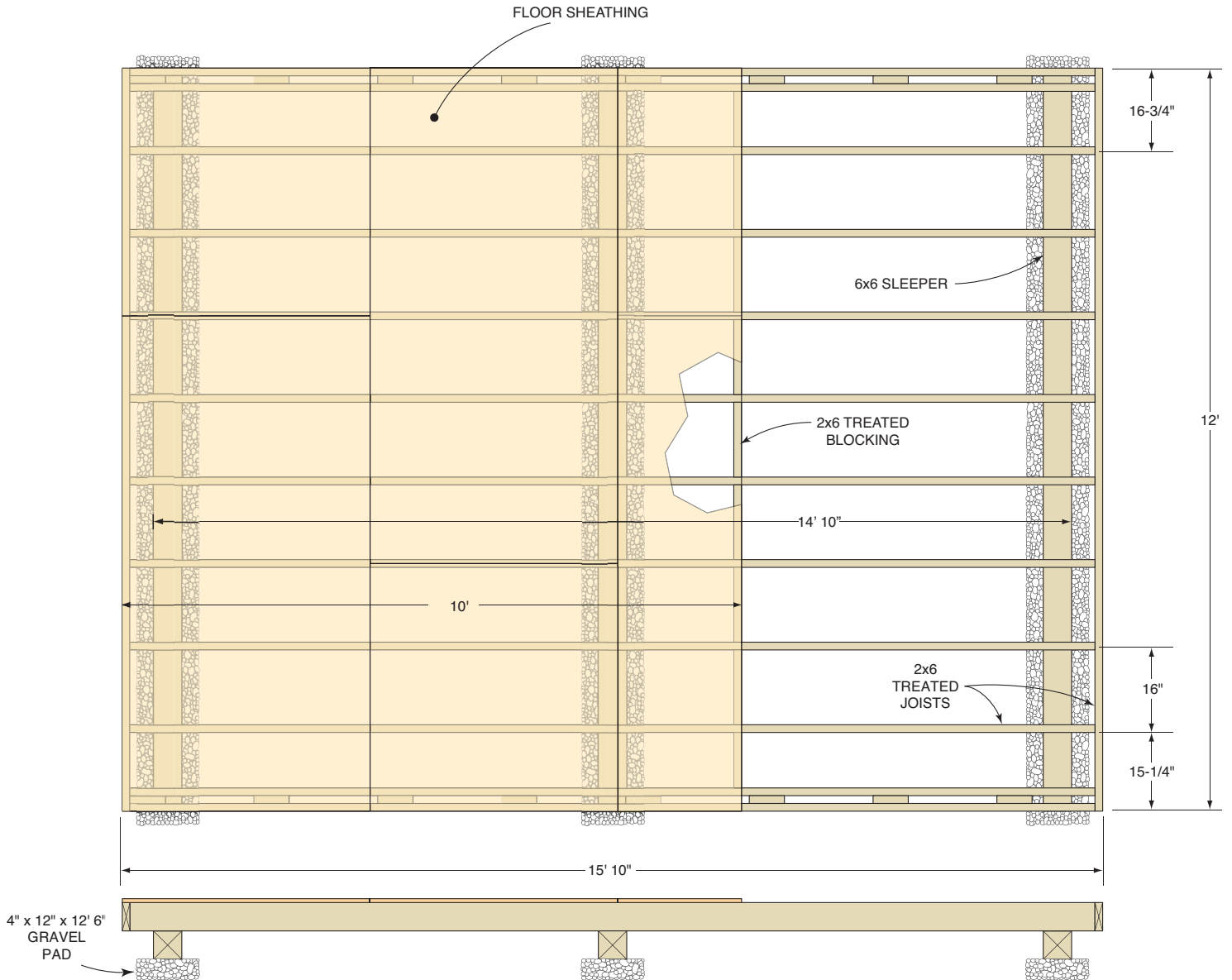

Figure C
Wall Placement

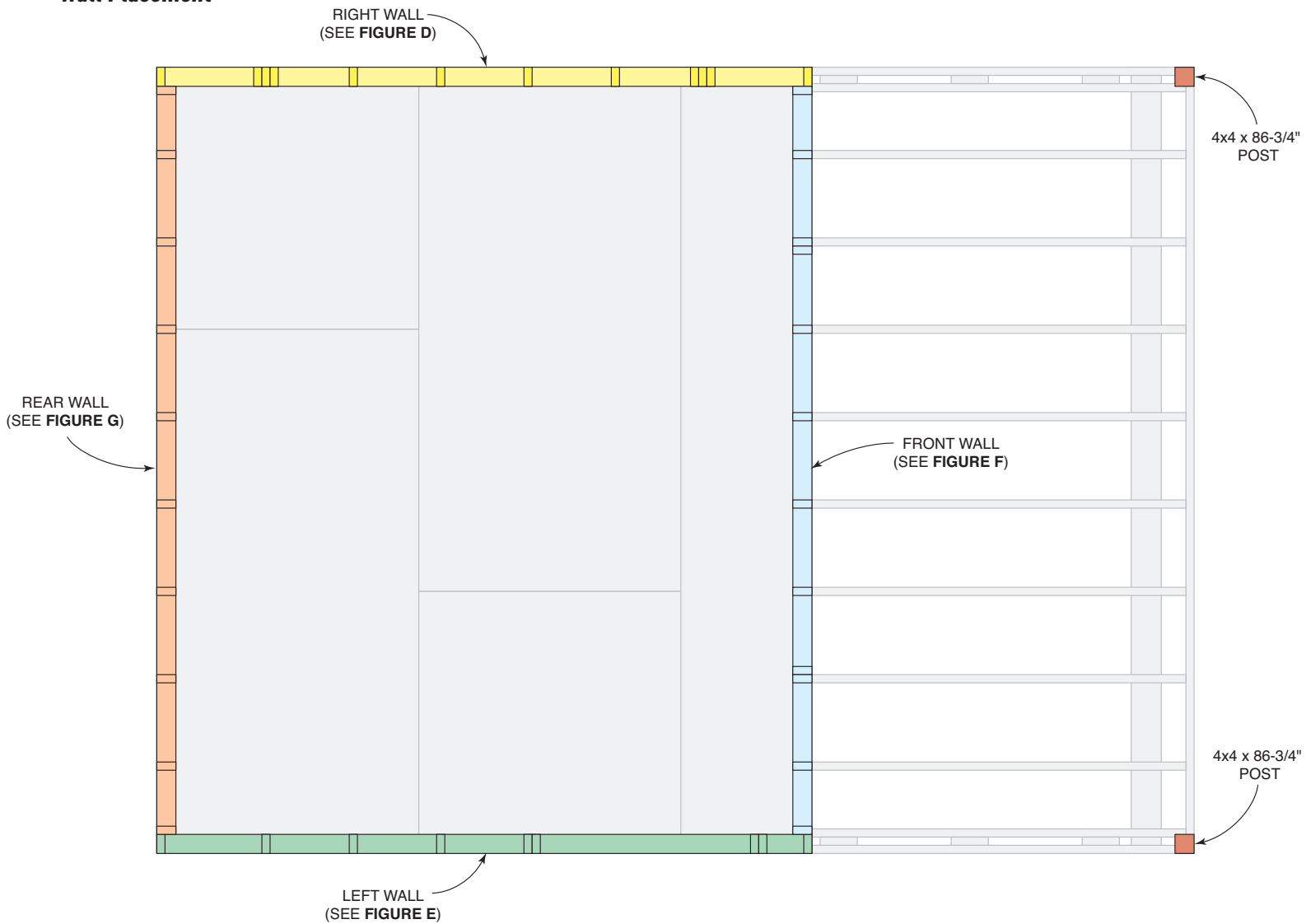

Figure D
Right Side Wall Framing and Siding

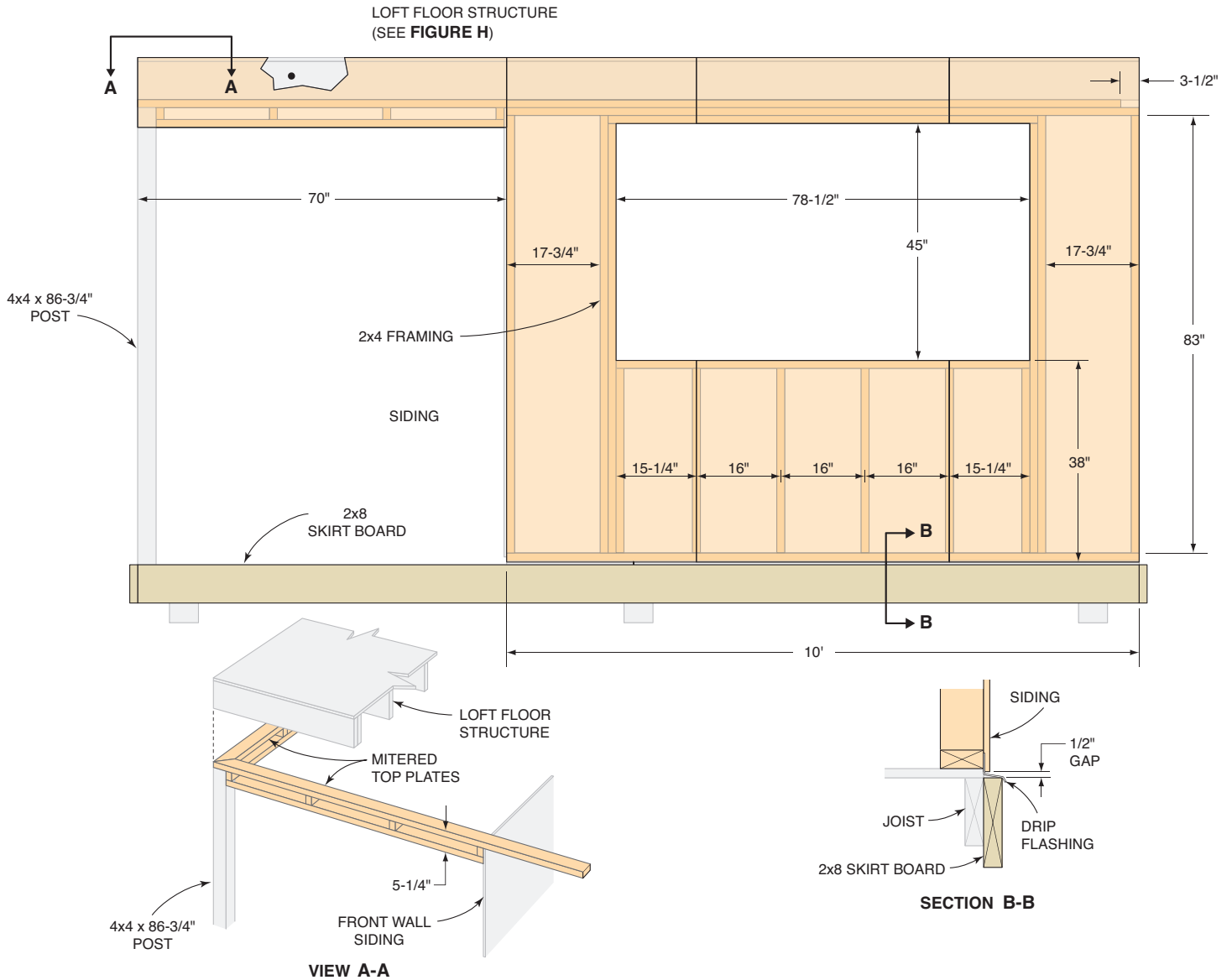

Figure E
Left Side Wall Framing and Siding

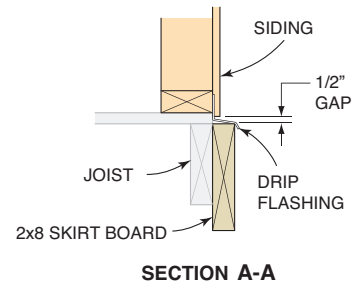
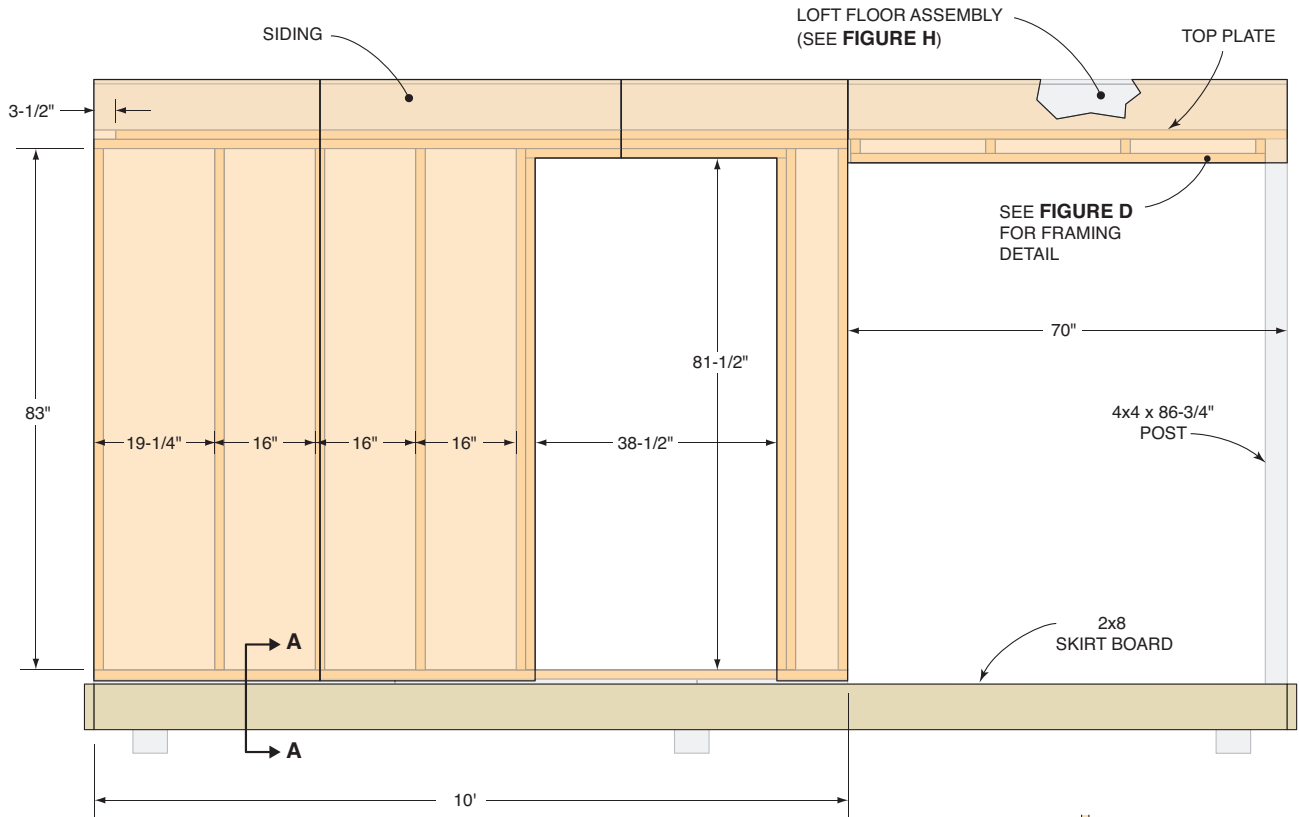

Figure F
Front Wall Framing and Siding

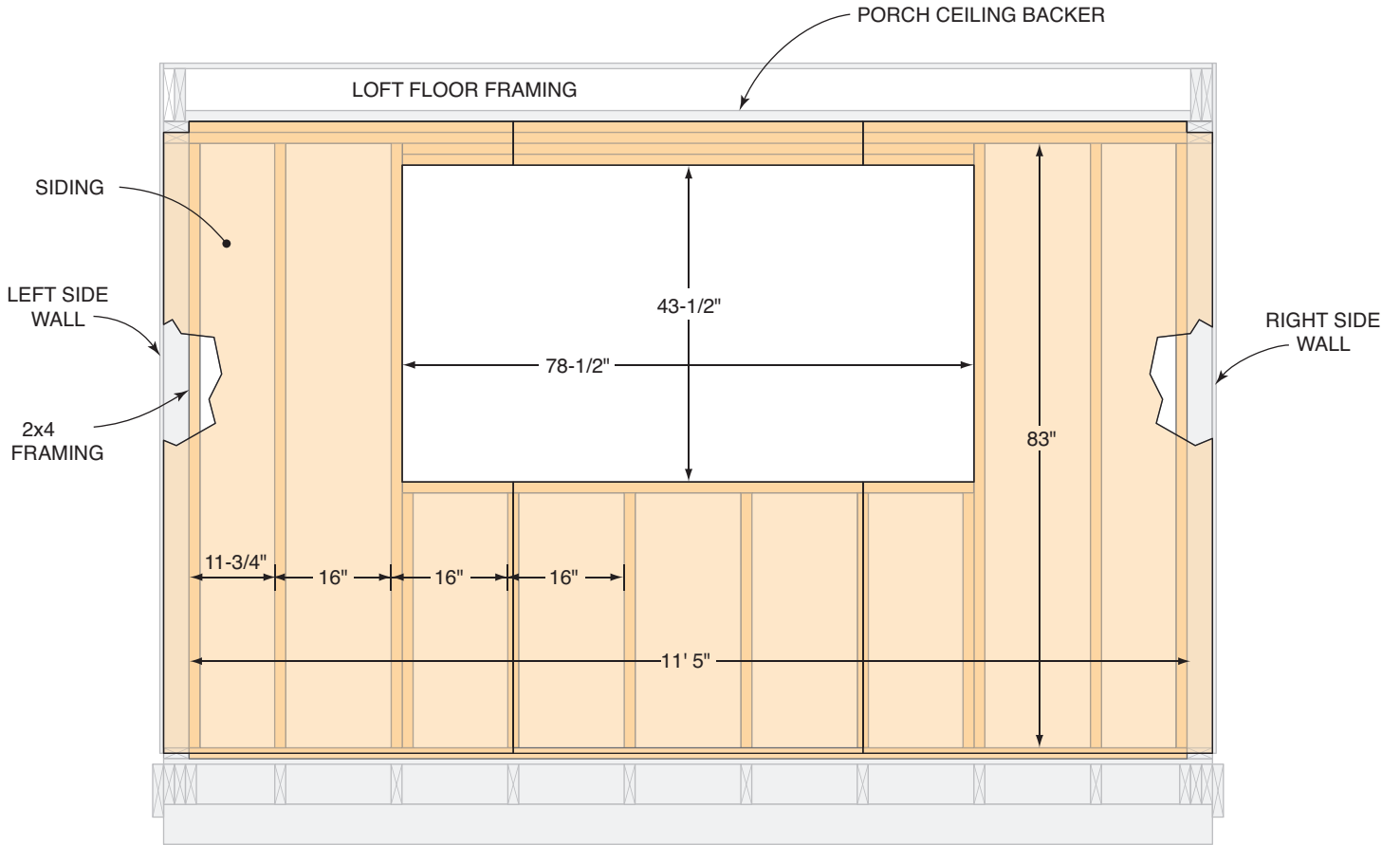

Figure 6 Rear Wall Framing and Siding

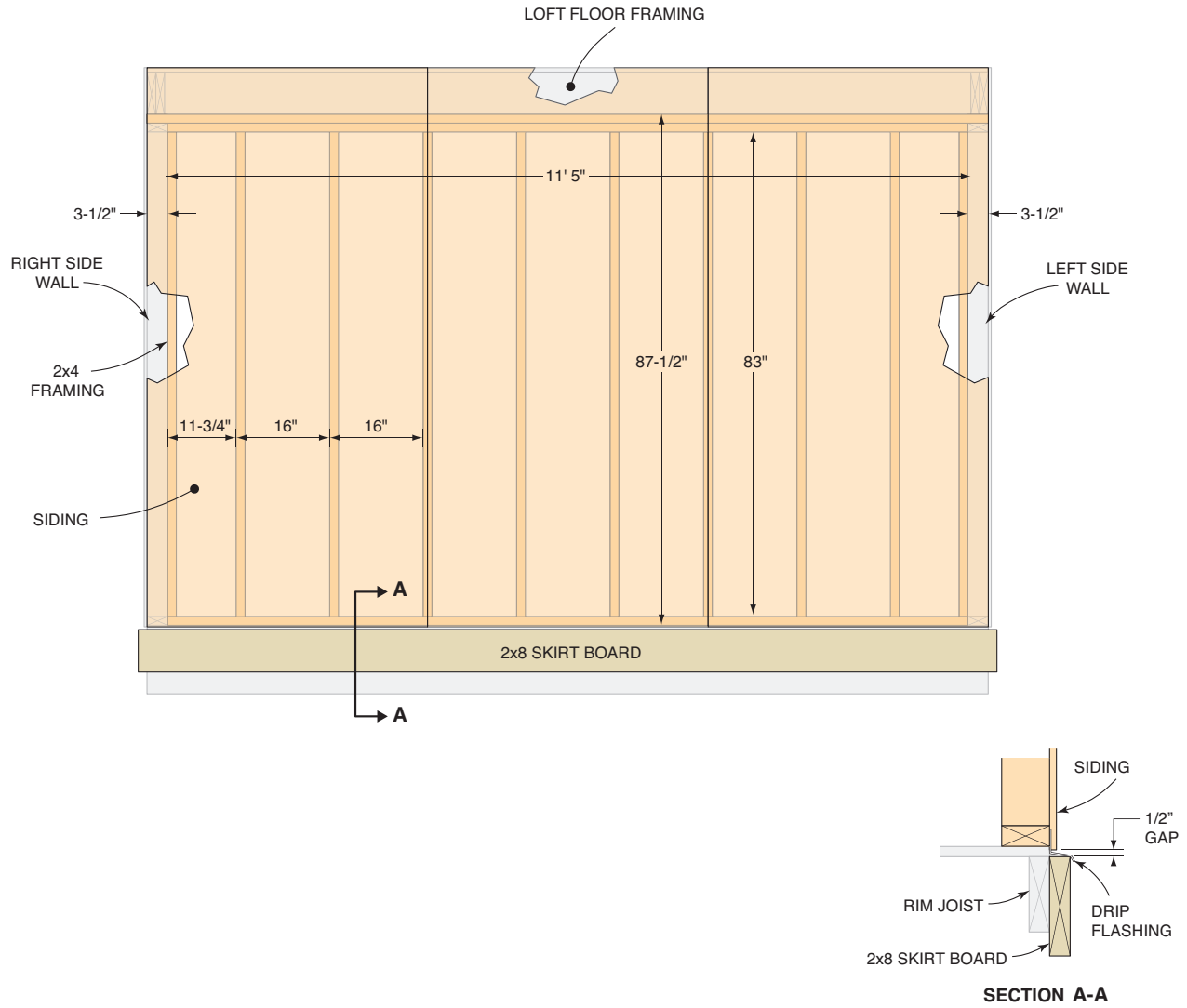

Figure H Attic Joists Framing and Flooring

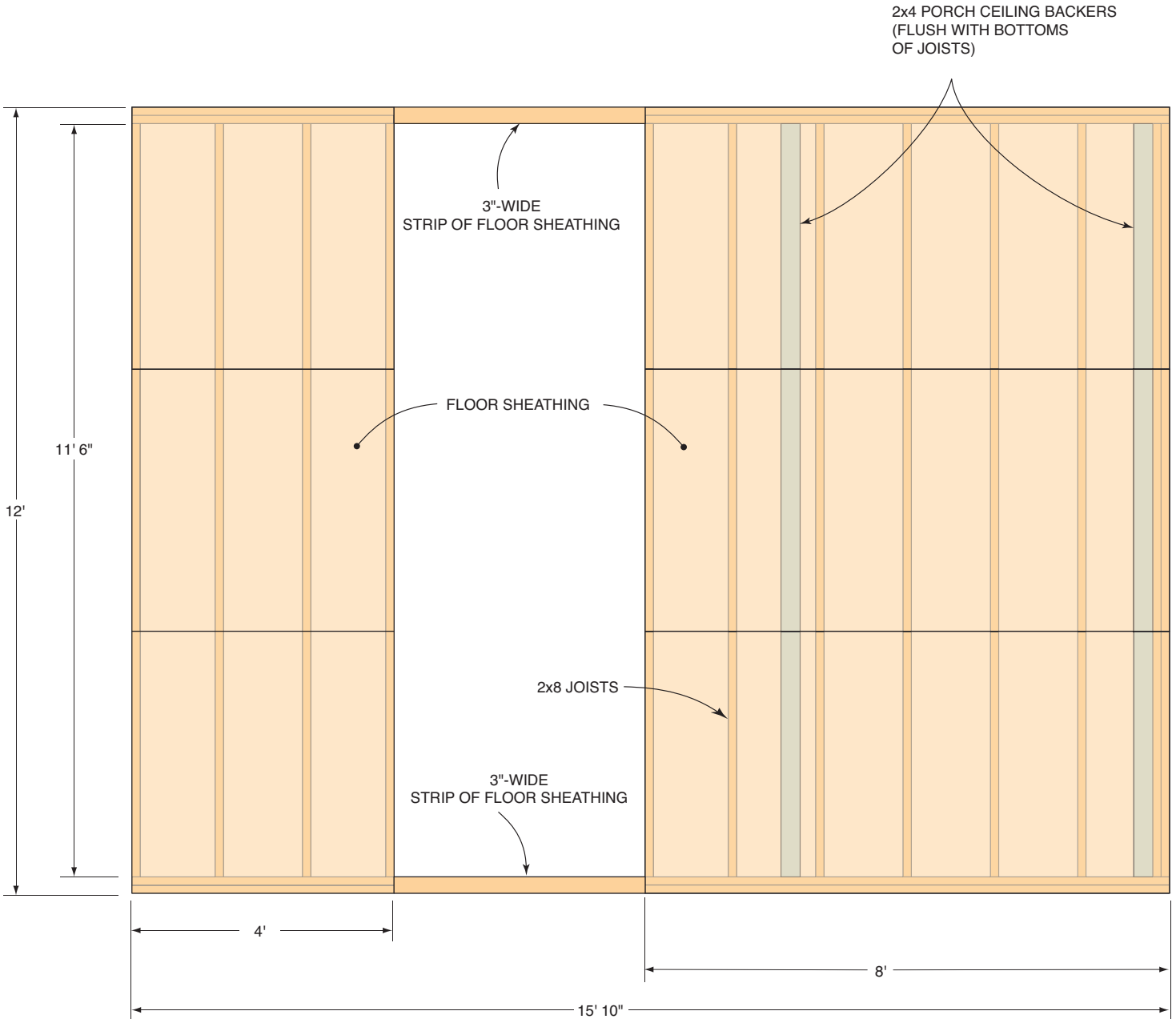

Figure J Rafters, Fascia and Gable Trim Patterns

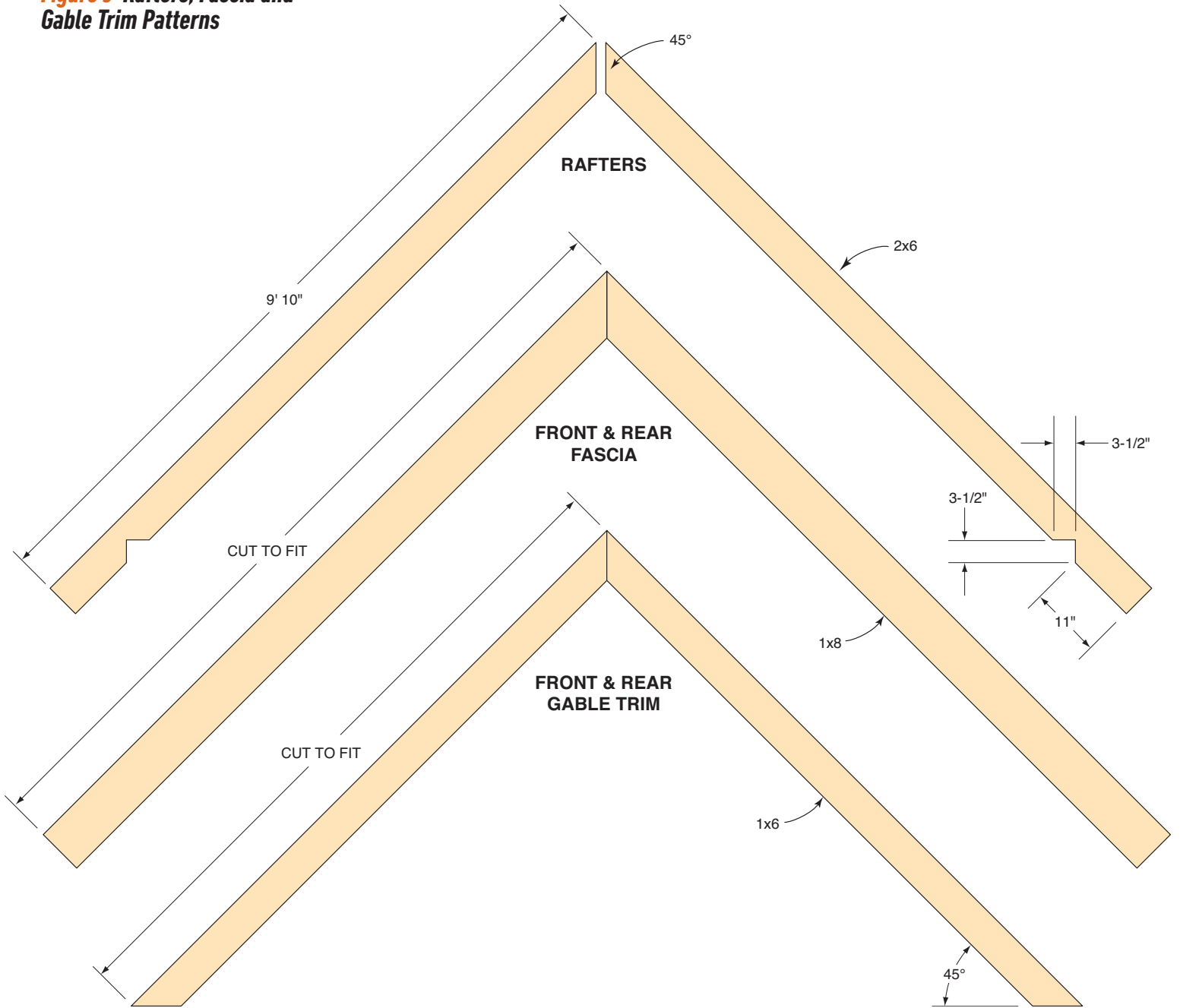
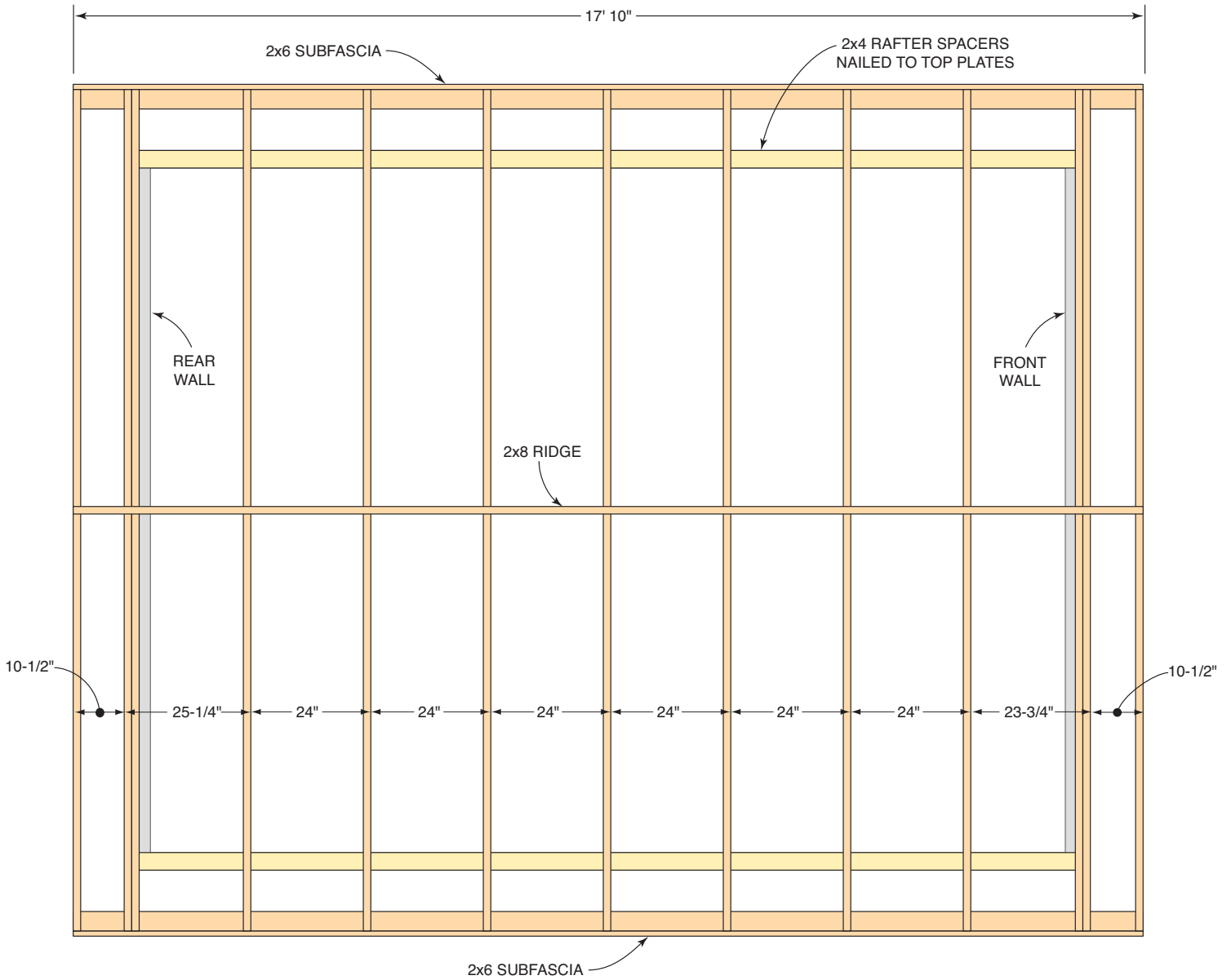

Figure K
Rafters Spacing Plan View



**Figure L Front and Rear Gables
Framing and Siding**

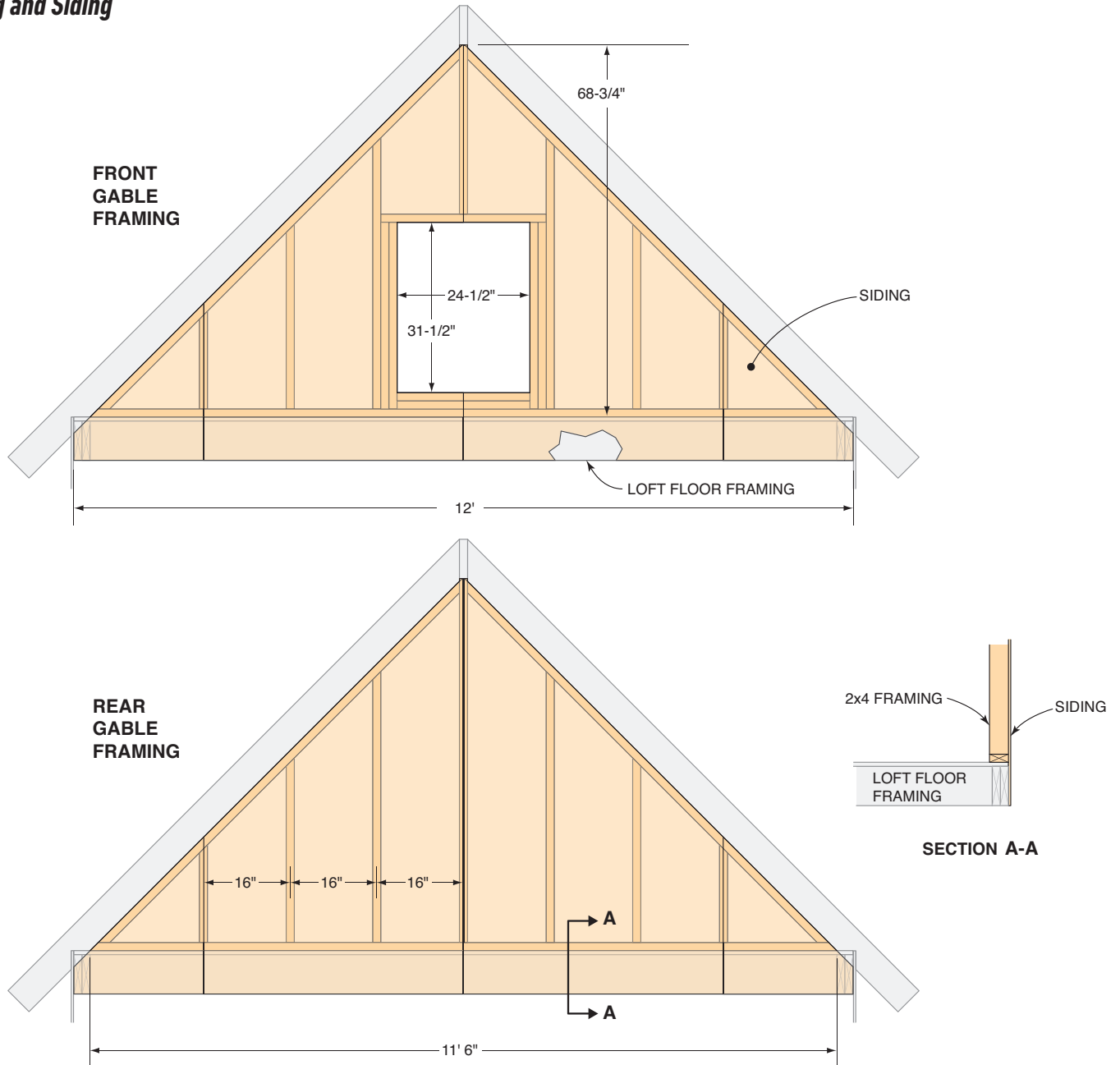

Figure M
Decking

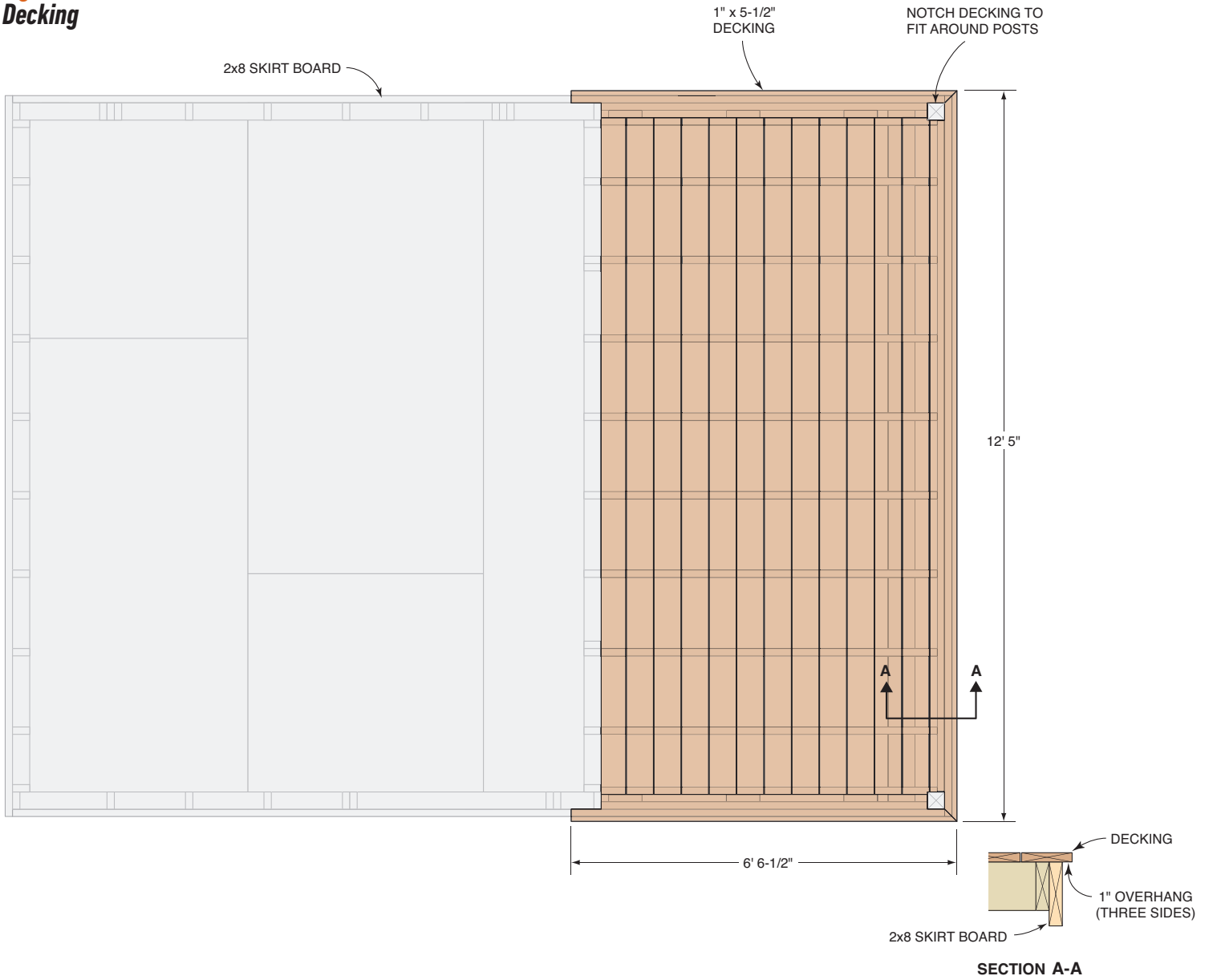

Figure N
Roof Sheathing



Figure P
Bar and Bar Door
Construction

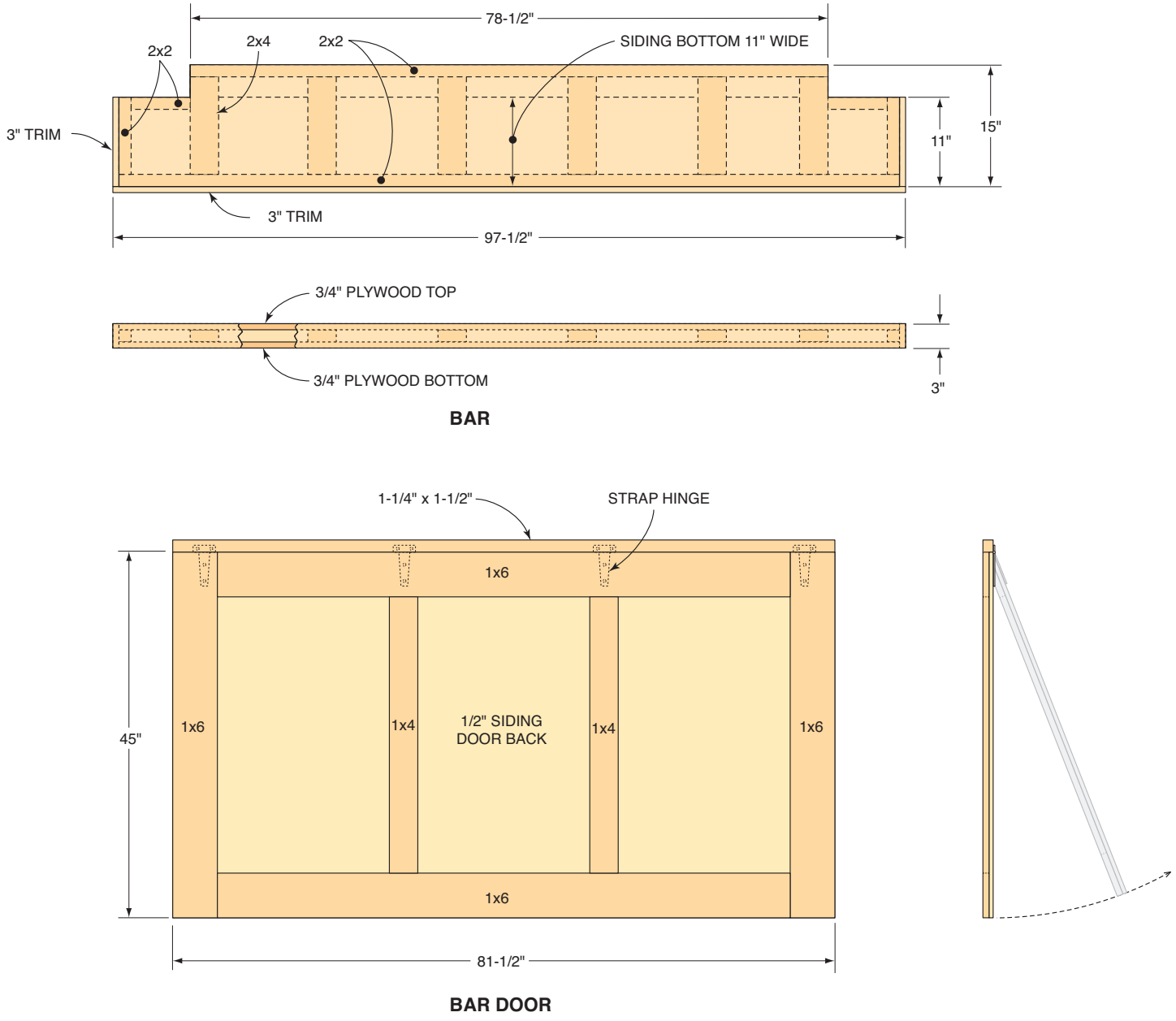
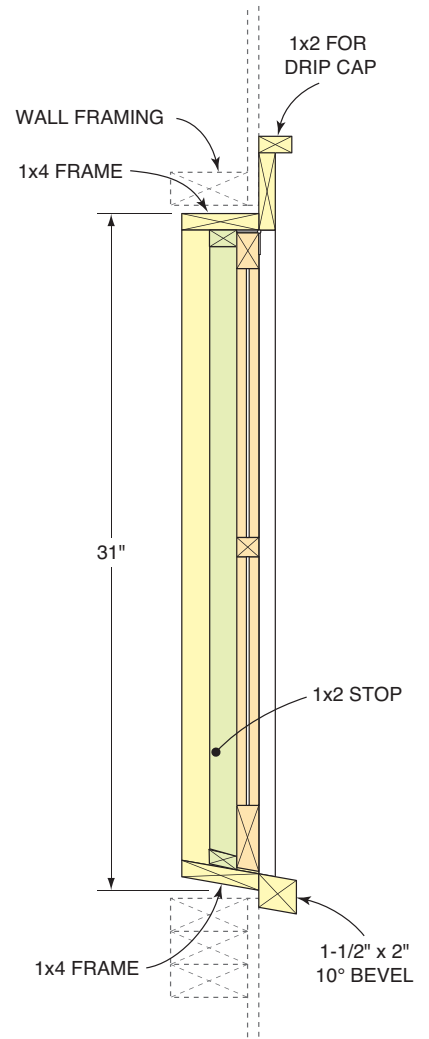
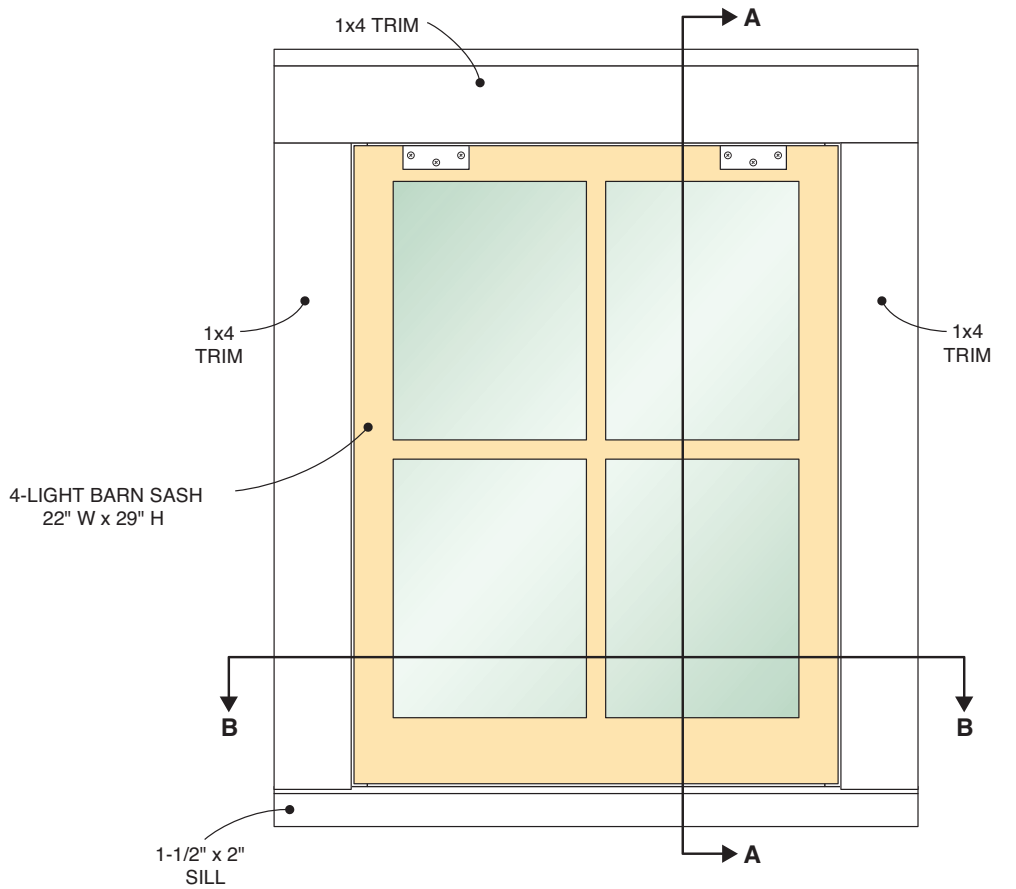
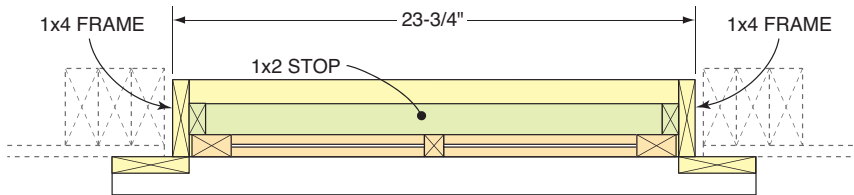

Figure Q
Front Window
Details



SECTION A-A



SECTION B-B

Figure R Side Windows Assembly

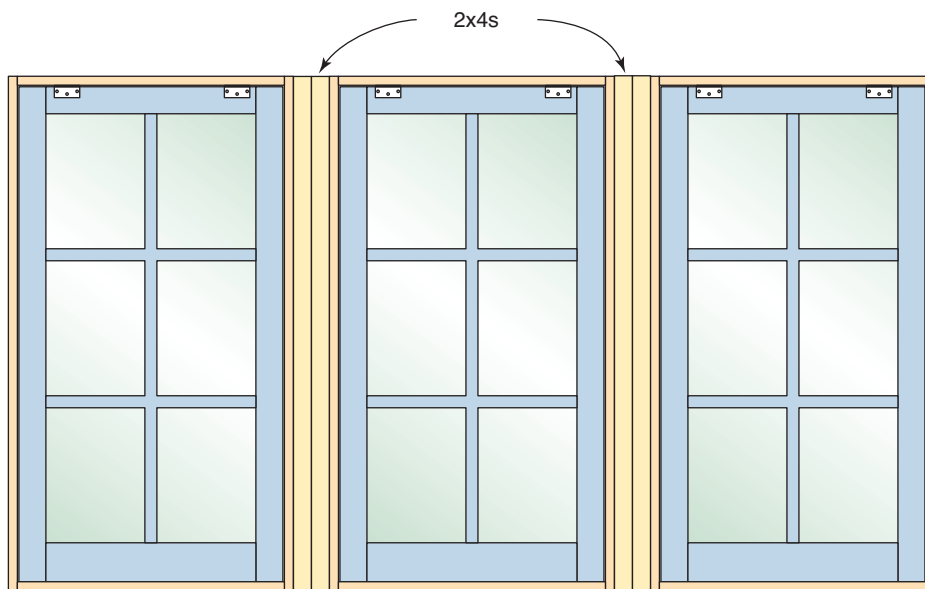
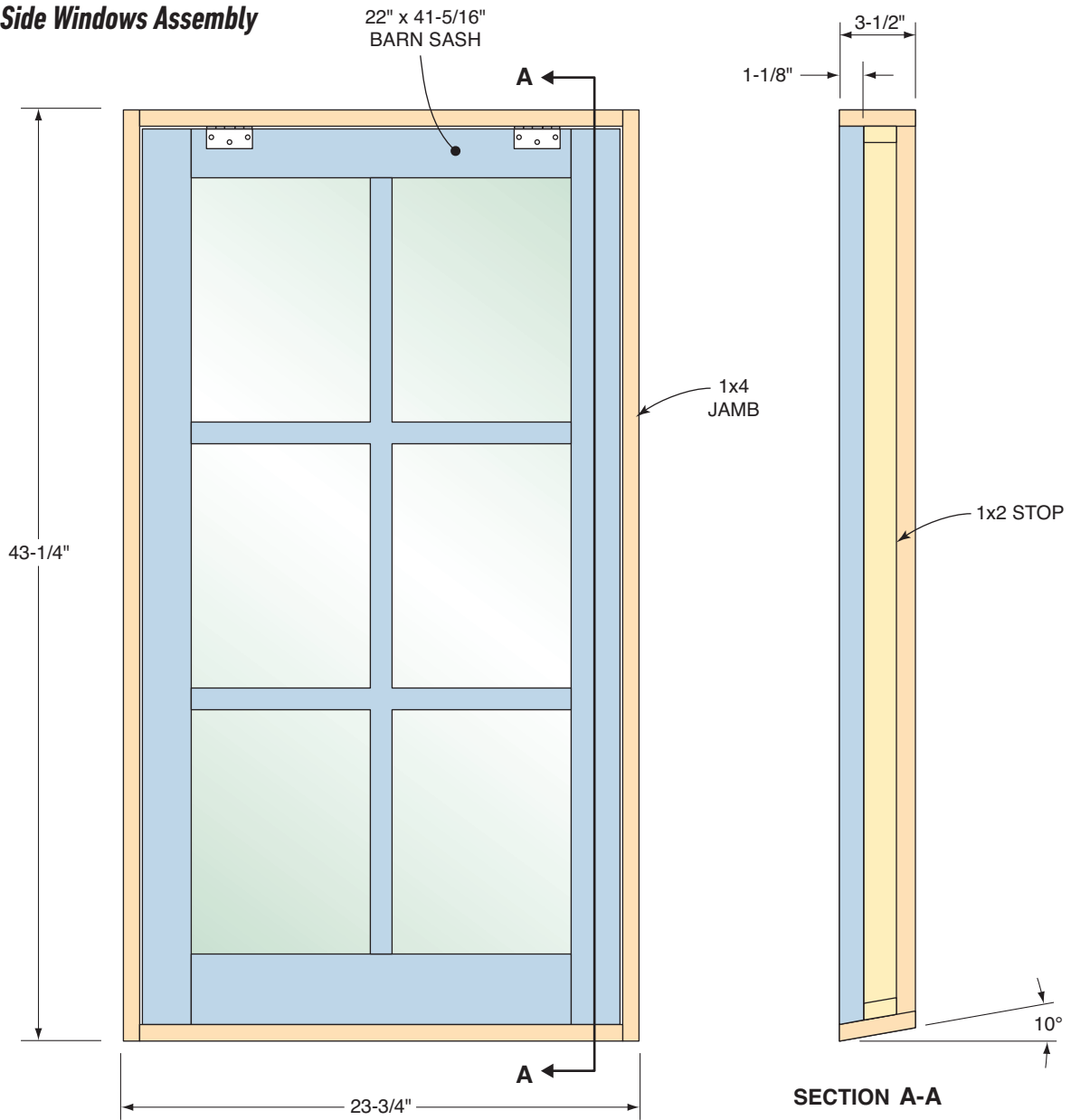

ASSEMBLED WINDOW UNIT

Figure S Front View

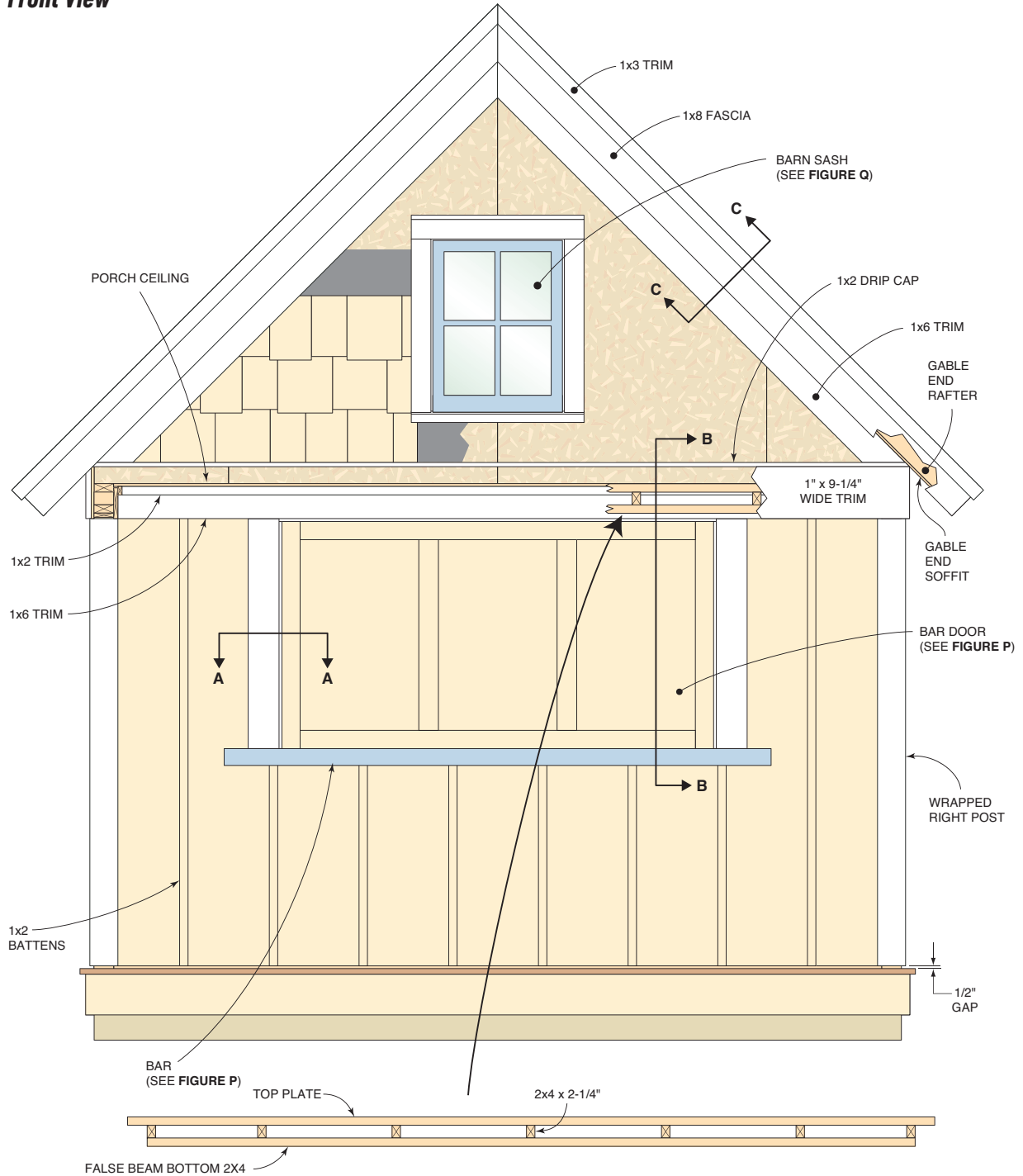
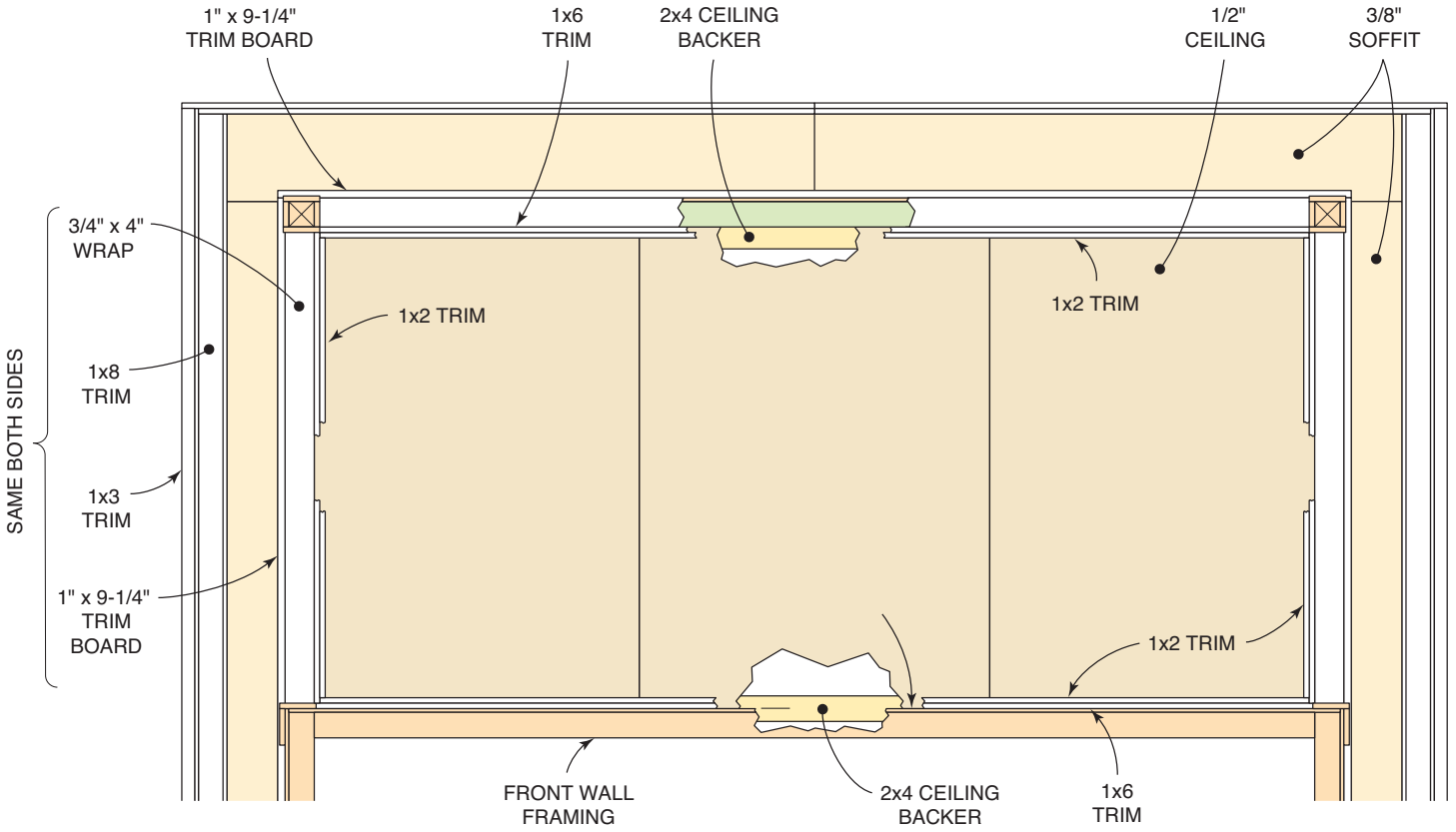
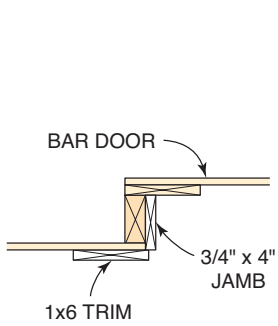

Figure T Front Wall Details



VIEW LOOKING UP



SECTION A-A
(SEE FIGURE S)

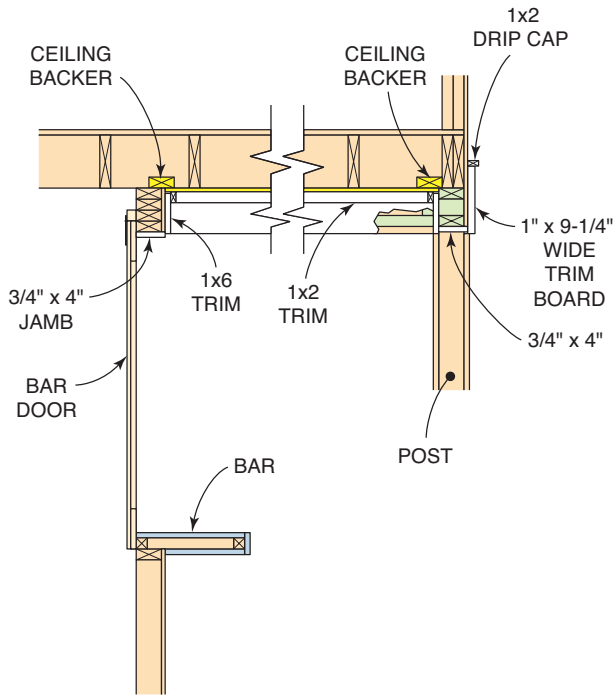

SECTION B-B
(SEE FIGURE S)

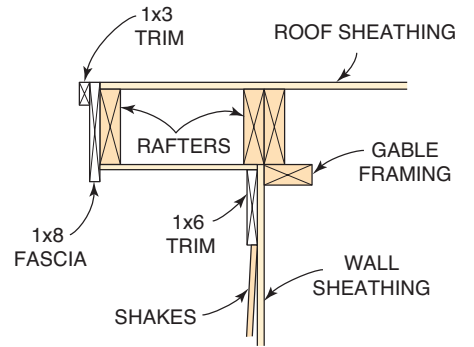

SECTION C-C
(SEE FIGURE S)

Figure U
Right Side Wall

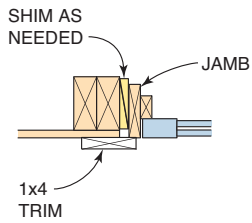
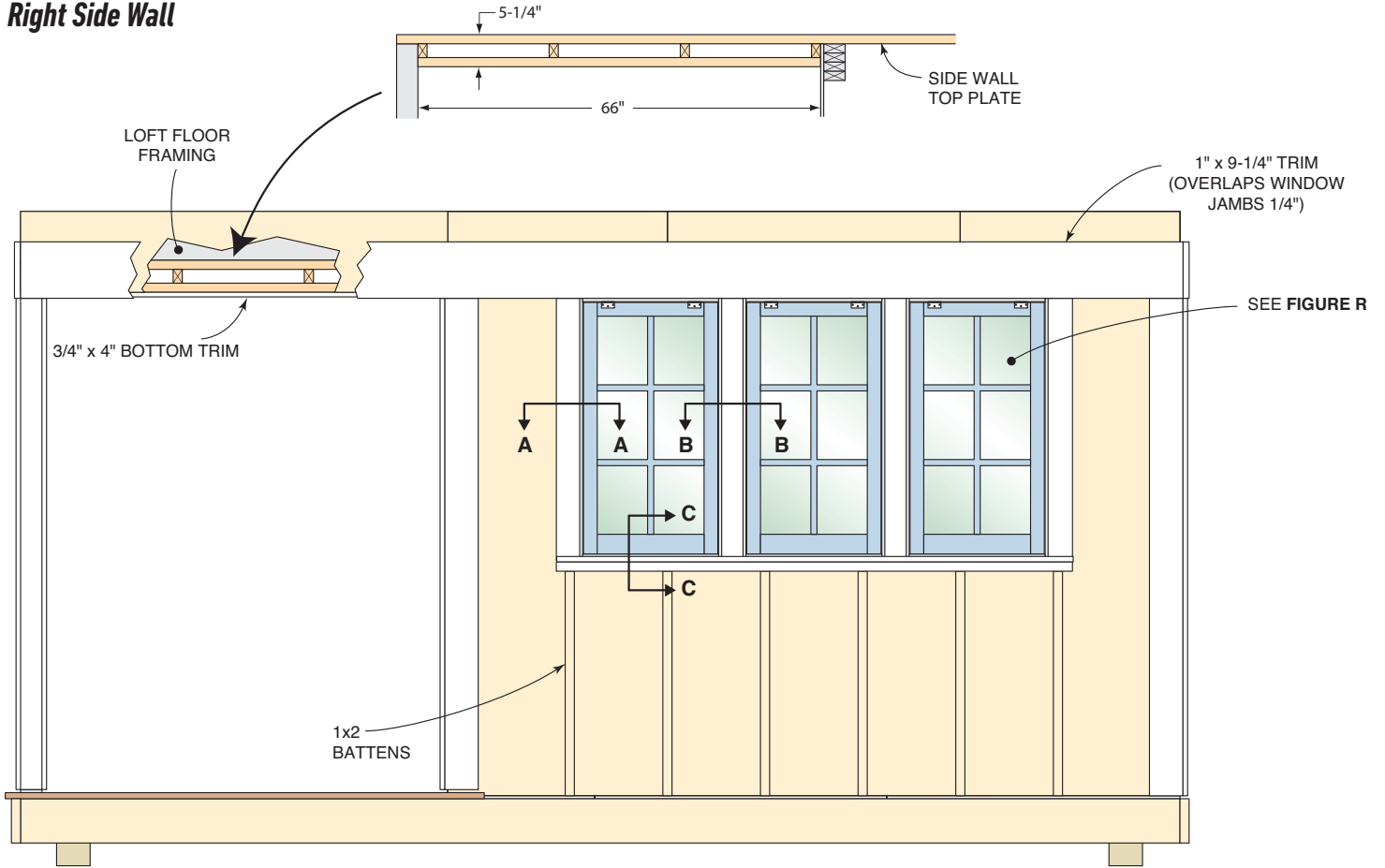

SECTION A-A

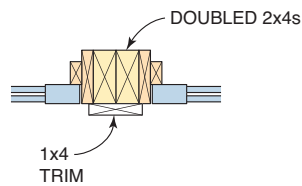

SECTION B-B

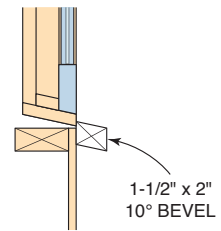

SECTION C-C

Figure V Left Side Wall

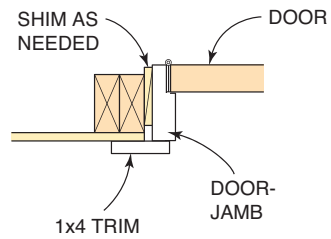
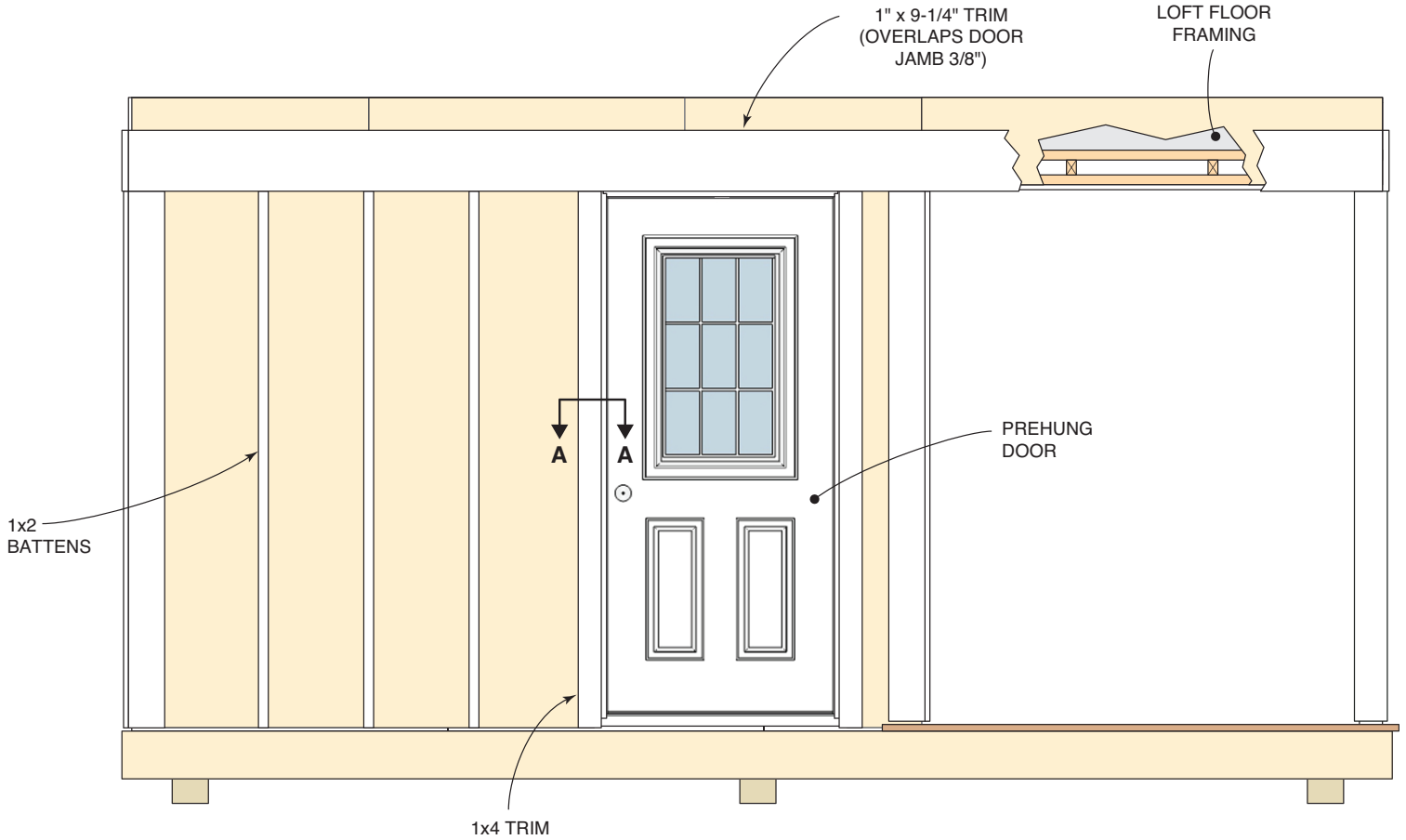

SECTION A-A